



CABLE STEERING SYSTEM ASSEMBLY GUIDE

39b Sonter Road, Sockburn
P.O. Box 20463
Christchurch 8543
New Zealand

Ph: 0064 3 343 0920
Cell: 0064 21 207 9743
Fax: 0064 3 343 0922
Email: ssseng@xtra.co.nz



NEW ZEALAND

DISCLAIMER

TRIPLE S ENGINEERING AND MARINE TECHNOLOGY LIMITED OR IT'S STAFF
CAN NOT BE HELD RESPONSIBLE FOR THE ACTIONS OF OTHERS.

THESE INSTRUCTIONS ARE PROVIDED AS A GUIDE OF BEST PRACTICE.
AND RELATES TO PARTS SUPPLIED AND MANUFACTURED BY
TRIPLE S ENGINEERING AND MARINE TECHNOLOGY LIMITED.

PLEASE READ AND UNDERSTAND THESE INSTRUCTIONS FULLY BEFORE YOU
BEGIN ANY WORK TO INSTALL THESE PARTS INTO YOUR BOAT

WHEN WELDING, CUTTING, DRILLING OR GRINDING ALWAYS USE THE
APPROPRIATE SAFETY EQUIPMENT.

AS ALL MOVING COMPONENTS ARE SUBJECT TO WEAR AND TEAR,
IT IS THE ULTIMATE RESPONSIBILITY OF THE BOAT OWNER TO ENSURE
REGULAR MAINTENANCE IS CARRIED OUT ON ALL MOVING COMPONENTS TO
KEEP THEIR BOAT IN A SAFE CONDITION FOR USE ON THE WATER.

WHILE WE HAVE DONE OUR UTMOST TO PROVIDE DETAILED, ACCURATE AND
CORRECT INSTRUCTIONS WE ADMIT THAT AT TIMES ERRORS OCCUR AND
SOME MAY STILL BE PRESENT IN THIS DOCUMENT.

IF YOU BELIEVE WE HAVE MADE AN ERROR IN THIS DOCUMENT PLEASE LET
US KNOW.

WE RESERVE THE RIGHT TO MODIFY, UPDATE OR CORRECT THESE
INSTRUCTIONS AS AND WHEN REQUIRED WITHOUT NOTICE.

CABLE STEERING SYSTEM ASSEMBLY GUIDE



PLANNING YOUR INSTALL CABLE LAYOUT

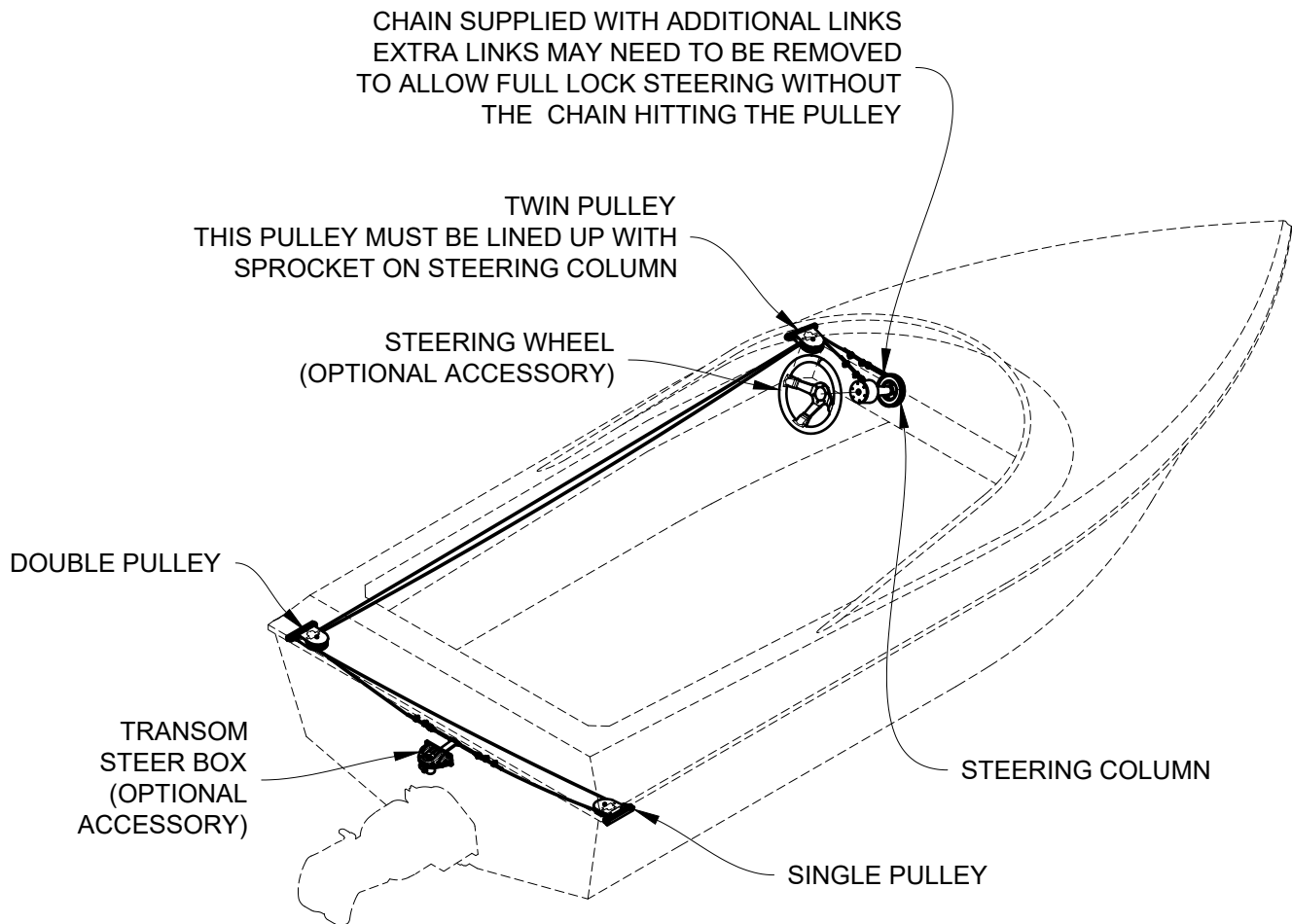

NOTES:

THE STEERING CABLE PROVIDED IS SUPPLIED AS A SINGLE 13m LENGTH.
IT MUST BE CUT INTO TWO PIECES TO SUIT YOUR BOAT.
THEY WILL NOT BE EQUAL LENGTHS.

MAKE SURE WHEN YOU TURN LOCK TO LOCK THAT THE CABLE ENDS DO NOT INTERFERE
WITH THE PULLEY CLOSEST TO THE STEERING COLUMN, OR TRAVEL INTO THE SPROCKET
SIDE PLATES.

IF NECESSARY CABLES CAN BE RUN DOWN OPPOSITE SIDE OF THE BOAT TO THAT SHOWN.

CABLE STEERING SYSTEM ASSEMBLY GUIDE

STEERING COLUMN INSTALLATION

1

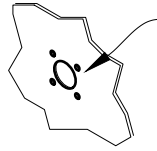

DRILL 1x Ø40.00mm HOLE IN DASHBOARD
FOR STEERING COLUMN SHAFT
AND
4x Ø8.00mm HOLES IN DASHBOARD FOR BOLTS
** SEE TEMPLATE FOR HOLE SIZE/POSITION DETAILS **

2

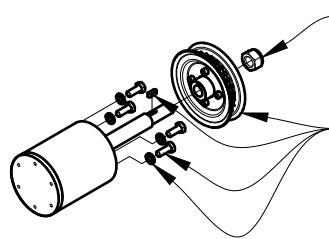

UNDO NYLOC NUT

REMOVE SPROCKET ASSEMBLY
SHAFT KEY, HEX BOLTS
& SPRING WASHERS

3

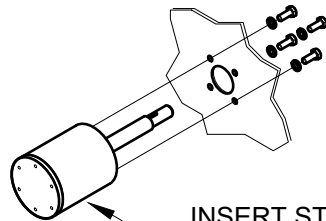

INSERT STEERING COLUMN INTO HOLE
AND BOLT IN PLACE FROM BEHIND DASHBOARD
USING BOLTS & SPRING WASHERS REMOVED IN STEP 2

4

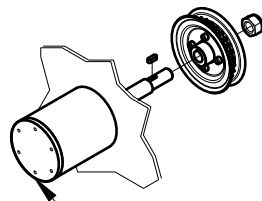

RE-ASSMBLE SHAFT, KEY,
SPROCKET ASSEMBLY & NYLOC NUT

STEERING WHEEL FLANGE COMES DRILLED WITH
6x HOLES M5 ON Ø70.00mm P.C.D. TO SUIT MOST
STANDARD AFTER-MARKET STEERING WHEELS
ALTERNATIVE P.C.D. CAN BE DRILLED AND TAPPED IN PLATE

CABLE STEERING SYSTEM ASSEMBLY GUIDE

STEERING COLUMN INSTALLATION MOUNTING TEMPLATE

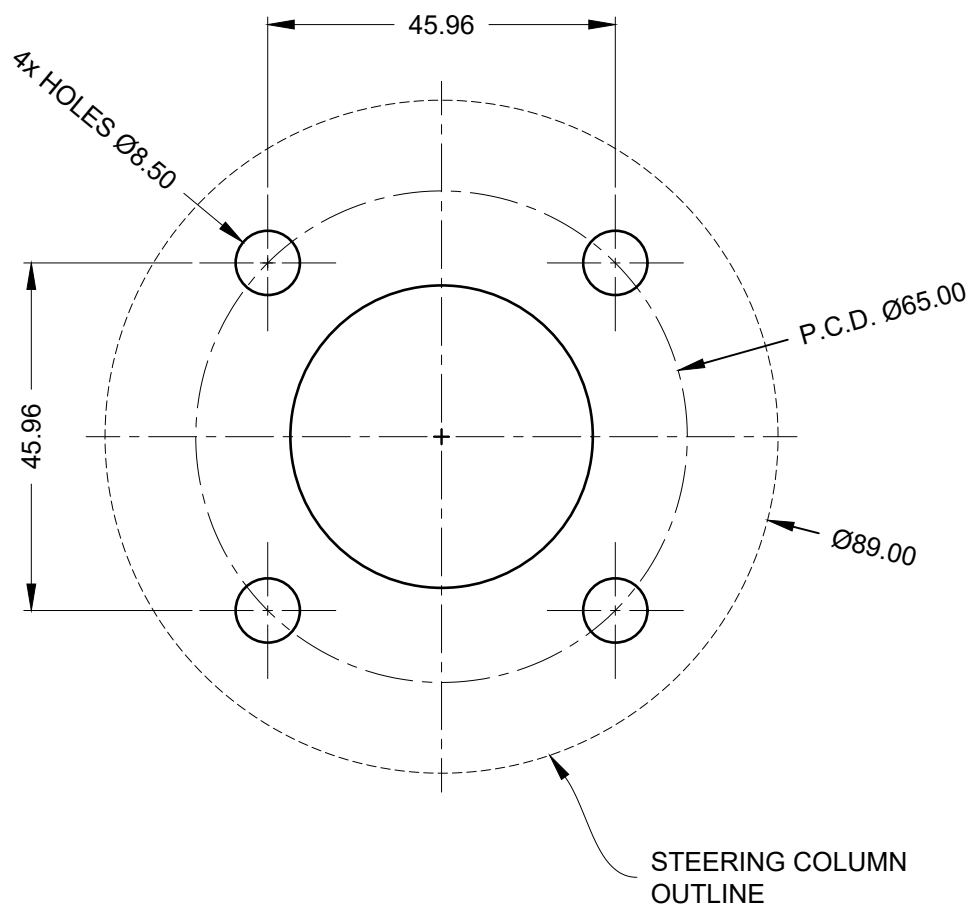

CABLE STEERING SYSTEM ASSEMBLY GUIDE

TYPICAL PULLEY MOUNTING DETAILS

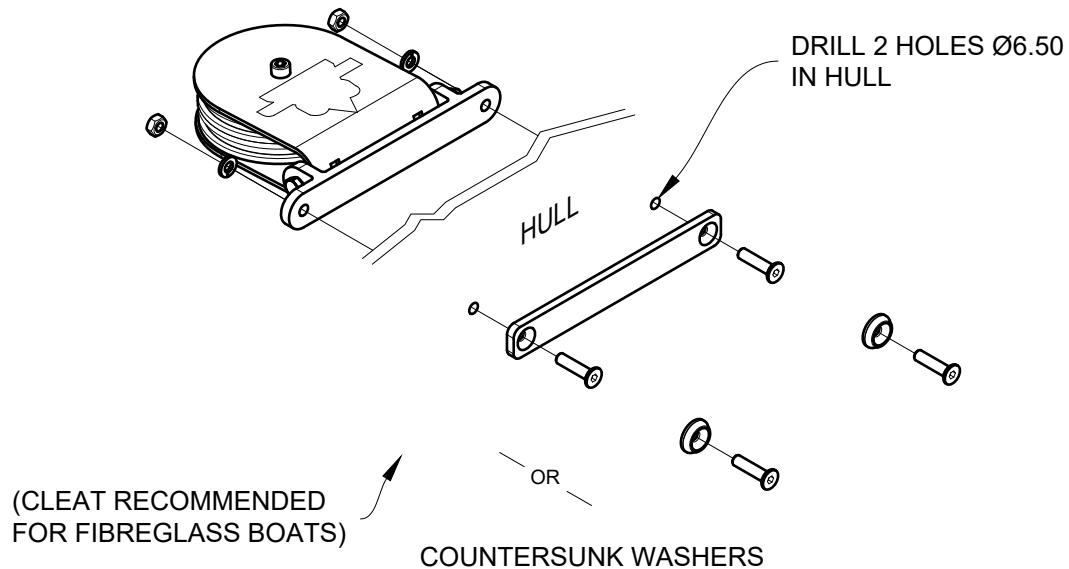

TYPICAL HOLE DETAIL FOR MOUNTING PULLEY

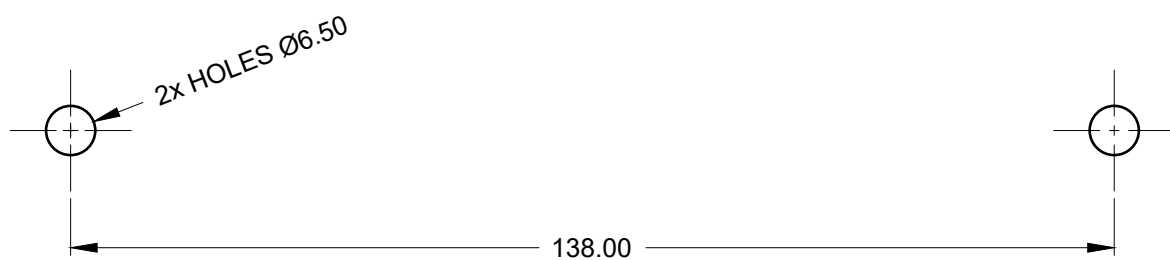

DIMENSION ABOVE IS A NOMINAL SIZE
USE PULLEY BRACKET AS TEMPLATE TO DRILL HOLES

CABLE STEERING SYSTEM ASSEMBLY GUIDE

TYPICAL CABLE END ASSEMBLY

1

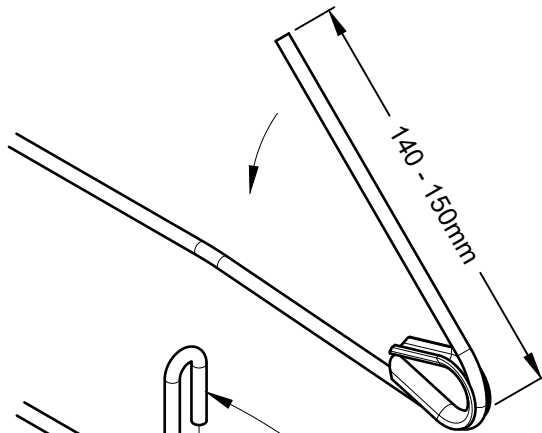

WRAP APPROX. 140 - 150mm OF
WIRE ROPE BACK AROUND
CABLE EYE

2

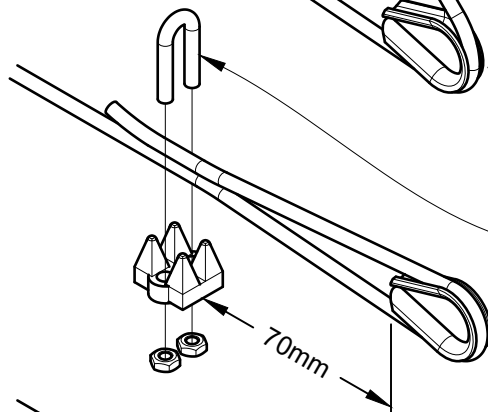

ASSEMBLE CABLE CLAMP
AROUND CABLE AS SHOWN.
APPROX. 70mm FROM THE
END OF CABLE THIMBLE AND
TIGHTEN NUTS ON U-BOLT

NOTE THE ORIENTATION OF
CLAMP AND U-BOLT IN RELATION
TO THE SHORT / DEAD END OF CABLE.
** IT MUST BE FITTED THIS WAY! **

3

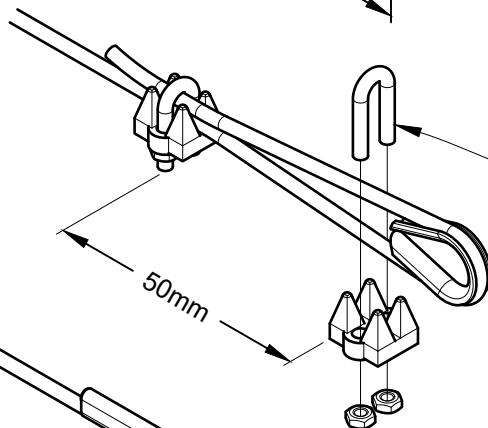

ASSEMBLE ANOTHER CABLE CLAMP
AROUND CABLE, CLOSE TO CABLE
THIMBLE AND TIGHTEN NUTS ON
U-BOLT

4

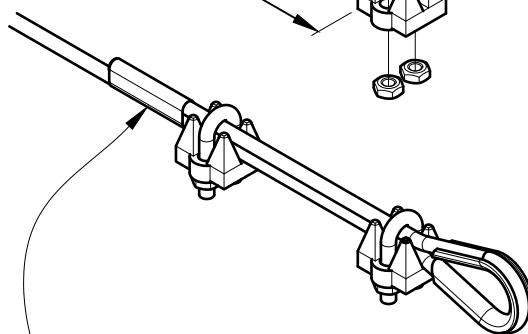

WRAP END OF WIRE ROPE WITH INSULATION TAPE,
HEAT SHRINK OR SIMILAR TO STOP FRAYING AND PREVENT
INJURIES OR CATCHING ON OTHER ITEMS.

CABLE STEERING SYSTEM ASSEMBLY GUIDE

TYPICAL CABLE END ASSEMBLY
CORRECT CLAMP FITMENT

WRONG!!

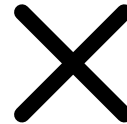
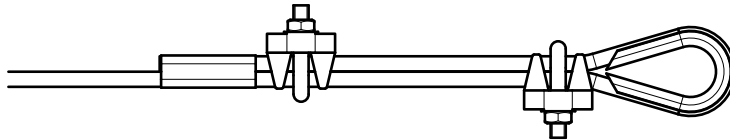

DO NOT STAGGER DIRECTION OF CLAMPS

WRONG!!

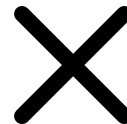
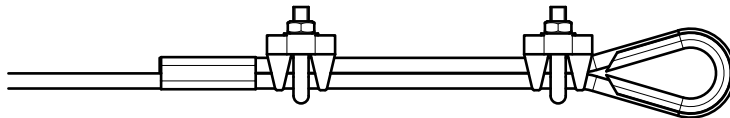

CLAMP BASE POSITIONED OVER
UN-LOADED / DEAD / SHORT END
OF CABLE

CORRECT

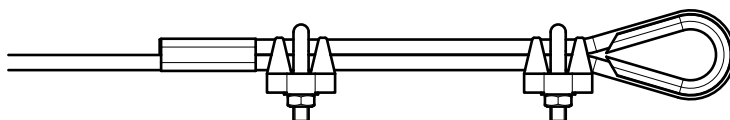

CLAMP BASE POSITIONED UNDER
LOADED / LIVE / LONG END
OF CABLE

REMEMBER
"NEVER SADDLE A DEAD HORSE"

CABLE STEERING SYSTEM
ASSEMBLY GUIDE

CABLE TO CHAIN CONNECTION

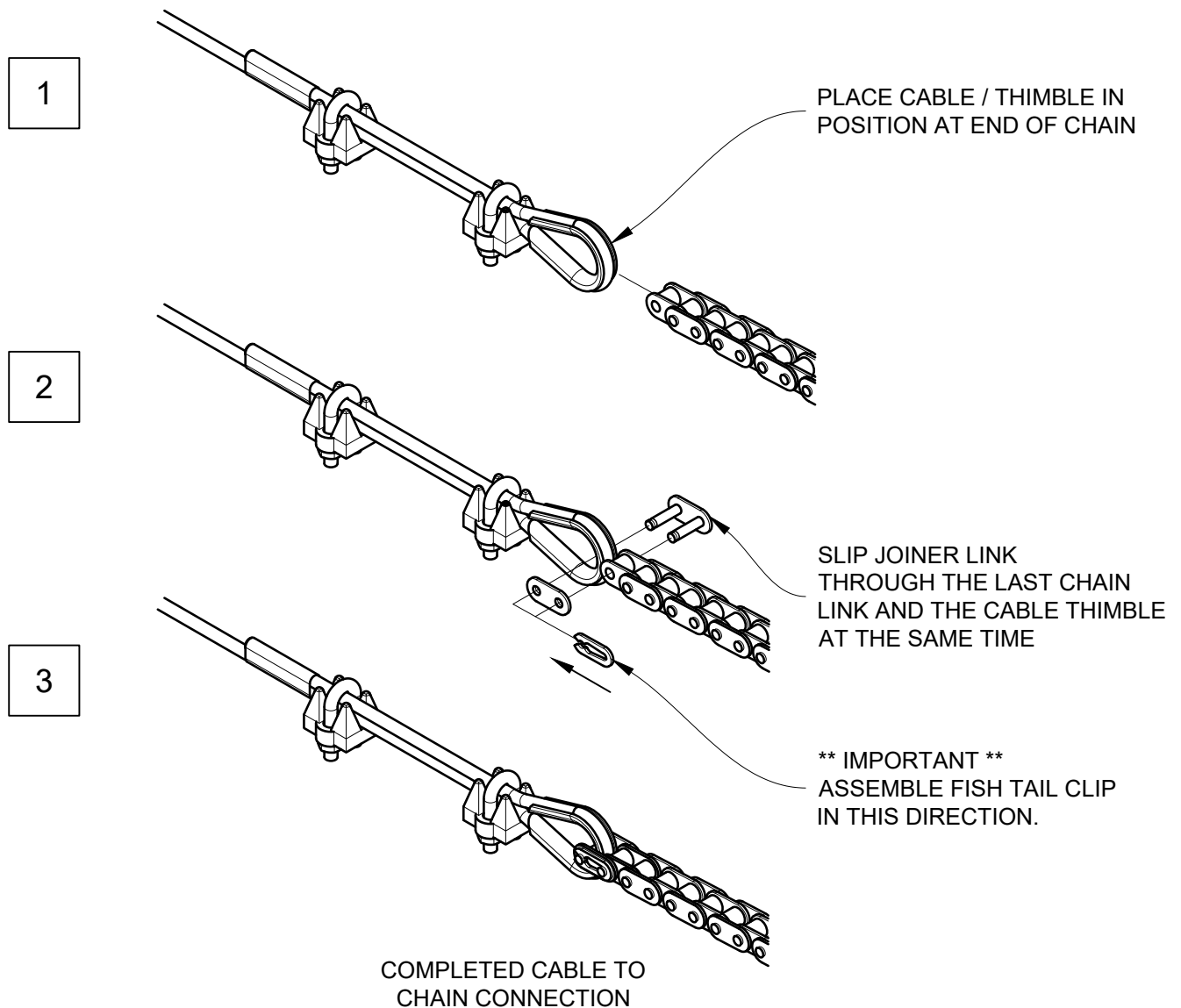

NOTES:

DO NOT SLIP JOINER LINK INTO POSITION BEFORE PLACING THE ASSEMBLED CABLE END AT THE END OF THE CHAIN

** IT WILL NOT FIT - DO NOT TRY TO FORCE IT **

CABLE STEERING SYSTEM ASSEMBLY GUIDE

CABLE TO TRANSOM STEER BOX CONNECTION

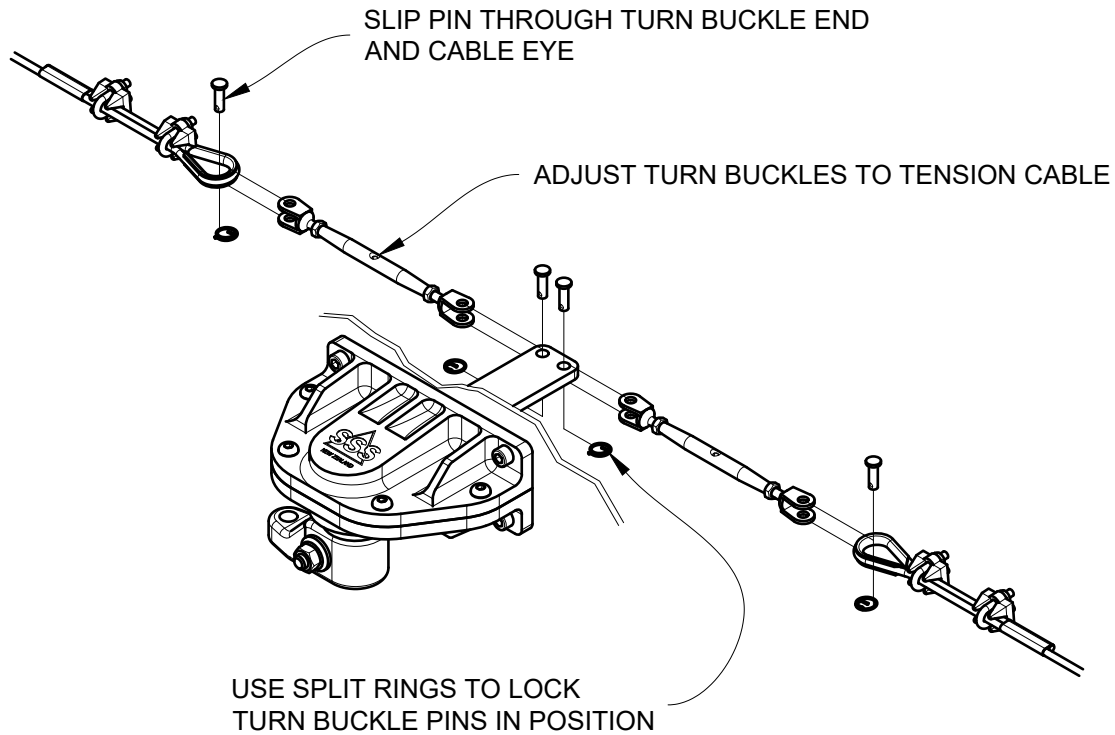

NOTES:

THIS PAGE ALSO APPLIES TO BOATS / JET UNITS WHICH DO NOT REQUIRE A TRANSOM STEER BOX - CONNECT THE CABLE TO THE STEERING ARM USING TURN BUCKLES AS SHOWN

CABLE STEERING SYSTEM ASSEMBLY GUIDE